

✓

Depreciation and  
Donation Line

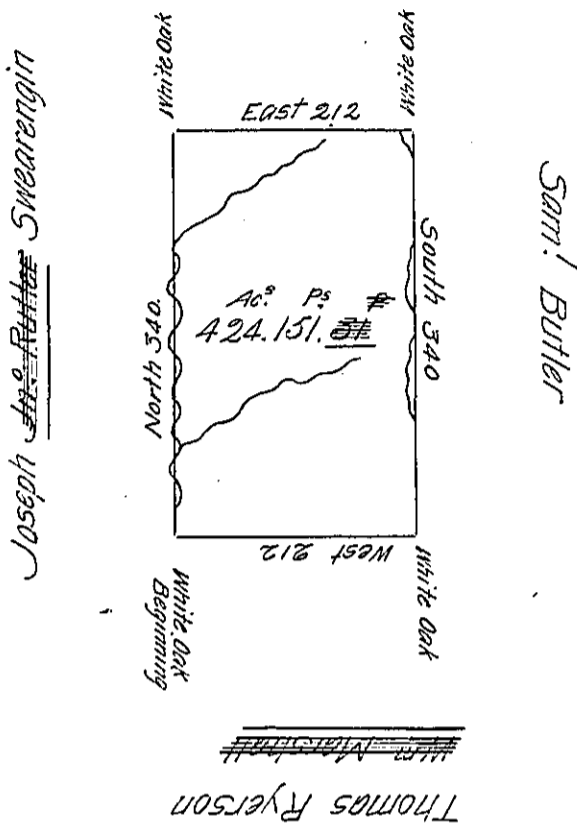

The above is a Draught of a Survey made the 26<sup>th</sup> of January 1795 in pursuance of a Warrant Granted to John Purviance for 400 Acres of Land Dated the 4<sup>th</sup> of January 1794 Situate North and West of the River Ohio on the Waters of Big Beaver Creek. & twenty four  $\frac{3}{4}$  thirty one poles Adjoining Land Granted to Thomas Ryerson Called Clayburn Containing four Hundred Acres and the Usual Allowance of Six P<sup>ct</sup> Cent for Roads.

Jonathan Leet, D.S.

To Daniel Brodhead Esq<sup>r</sup>  
Surveyor General

IN TESTIMONY that the above is a copy of the original remaining on file in the Department of Internal Affairs of Pennsylvania, made conformably to an Act of Assembly approved the 16th day of February, 1833, I have hereunto set my Hand and caused the Seal of said Department to be affixed at Harrisburg, this twentyfourth day of May 1906.

*Isaac B. Johnson*  
Secretary of Internal Affairs.